

 **Full Spectrum Solutions**
UltraLux 36w Sun Lamp Plus Floor Lamp



- The most advanced task lamp you can buy.
- Fully dimmable - like five lamps in one.
- High CRI and 40% brighter than similar lamps.

Full Spectrum Solutions
P.O. Box 1087 ~ Jackson, MI 49204
888-574-7014 ~ www.fullspectrum solutions.com

Dear Customer,
Congratulations, you have just purchase a quality full spectrum light fixture from Full Spectrum Solutions. Your lamp has been produced with the finest components available.

Be sure to retain your receipt for warranty purposes. Put it with this form and keep it accessible should you happen to need it for future reference. If you have a warranty claim or you have questions about the product, please contact the dealer where you purchased your light.

LOCATE INCLUDED PARTS:

- The lamp parts include the lamp head and bulb, the lamp pole, and the lamp base.
- The free extra bulb is located in a special slot on the back of the styrofoam packaging and is labeled.
- The screws and Allen wrench needed for assembly are in a small plastic bag in a styrofoam compartment.

ASSEMBLY AND START UP:

- Locate the top of the lamp pole that is slotted. Gently pull the wires so that the red and white connectors are easily accessible.
- Plug the red and white connectors from the lamp pole into the same color connectors located on the head of the lamp with the flexible portion.
- Insert the lamp pole into the flexible portion and attach it with the provided screws.
- Remove the red sleeve from the end of the pole. Gently pull and fold the extra wires into the bottom of the lamp as indicated on diagram 1.
- Insert the lamp pole into the socket of the base and attach it with the provided screws. The pole will not screw in if it is upside down.
- Take the bulb and plug it into the lamp socket. Make sure that the bulb is in all the way and the end of the bulb rests in the metal clip.
- Plug the lamp into the wall socket and turn the switch all the way to the right. This is the high setting. Each time you turn your lamp on your want to start it this way. Do not turn the dimmer down until the bulb lights up on high.
- Once your light comes on you need to leave it on for at least 2 hours in the high position to burn in your bulb for dimming. You only need to do this each time you use a new bulb.
- After you have finished the 2 hour burn in period you then can start dimming the lamp.
- If your lamp was delivered in the winter months you will need to wait until the unit gets to room temperature before starting the burn in process.
- We also recommend test the free extra bulb.
- The white silicone substance on the bulb acts as a stabilizer and should not be removed. It is not a fire hazard.

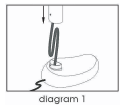

GENERAL RECOMMENDED USE FOR TASK LIGHTING:

- This product is excellent for reading, detail work, color matching, and computer work.
- If you find that the lamp is too bright on the high setting, simply dim it down to a more comfortable level. You may wish to reduce the light to a lower level in the evening..
- It can take up to two to three minutes for this lamp to reach its full light output. If for some reason your light does not come on please take the bulb out and reinsert following directions above. Make sure the bulb is in all the way. If your light still does not come on see the troubleshooting section.

TROUBLE-SHOOTING AND RE-SET INSTRUCTIONS:

• STEP ONE: CHECK THE BULB FOR DAMAGE

Make sure that the bulb does not have any visible damage such as a crack or hole. If you have an extra bulb check it as well.

• STEP TWO: CHECK THE LAMP CONNECTIONS

Please check the connections in the lamp and make sure that the wires are folded inside the pole toward the bottom of the lamp near the base and not toward the top.

• STEP THREE: CHECK BULB INSTALLATION

Please take a close look at the bulb and the lamp holder so you can see where it needs to be in all the way. The male connector in the middle at very end of the bulb needs to be in all the way so that you cannot see any part of it. It can go in hard at the end. Use the four fingers on your right hand and place them over the end of the tubes and then use your thumb on your left hand and put between the tubes at the base of the bulb. Also use your fingers to squeeze the head while you are pushing the bulb in with your thumb. If you use both hands at the same time while doing this, you are sure to get it in all the way.

• STEP FOUR: RESET LAMP

Make sure the dimmer switch is off, all the way to the left. Unplug the lamp and let it sit for five minutes. Before you plug it back in turn the switch all the way to the right. This is the high setting. Now, go and plug it back in with the switch in the full on position. The lamp should come on right away. It should start each time if you turn the switch on this way. In other words, the light needs to be on high when you first turn it on, so just turn the dimmer switch all the way to the right and let it start. If these steps do not solve the problem, see the warranty section.

WARRANTY CLAIMS, DAMAGE CLAIMS, AND RETURNS FOR A REFUND

If you purchased this product from a dealer other than Full Spectrum Solutions, you will need to contact that dealer.

If you purchased from Full Spectrum Solutions:

Go to the website at www.fullspectrumolutions.com for details on how warranty claims, damage claims, and returns for a refund are handled.

ULTRALUX LIMITED WARRANTY AND EXCLUSIONS:

UltraLux units are warranted to be free from defects in material and workmanship for two years from purchase date. Warranty on lamp (bulb) is one year. We must receive all warranty parts shipped pre-paid by the customer. Any structural damage to components voids any and all warranties. If you have a broken bulb during shipment, you have two weeks from the shipment date to make a damage claim. Bulbs broken by the customer are not covered under the warranty.

No other warranties are expressed or implied. We make no medical claims as to the use of this unit. When returning a unit, be aware that damage during shipping is the responsibility of the purchaser and will void any warranty claim. We recommend that you purchase insurance when shipping this unit or any parts. Full Spectrum Solutions makes no other warranty, expressed or implied, and makes no warranty of merchantability or fitness for any particular purpose.

This warranty only covers failures as stated above, which occur during normal use and in accordance with application guidelines. Full Spectrum Solutions shall not be held liable for incidental or consequential damages resulting from the use of this product or arising out of any breach of this warranty. Purchaser agrees by the act of purchasing this product to the terms stated here in. Except as stated above Full Spectrum Solutions makes no representations or warranties, express or implied (including the implied warranties of merchantability and fitness).